



LEGEND

	STAGE 1 – 50 LOTS
	STAGE 2 – 45 LOTS
	STAGE 3 – 53 LOTS
	STAGE 4 – 43 LOTS
	STAGE 5 – 20 LOTS
TOTAL 211 LOTS	

HAMLET 'A'
TOTAL LOTS = 50

HAMLET 'B'
TOTAL LOTS = 161

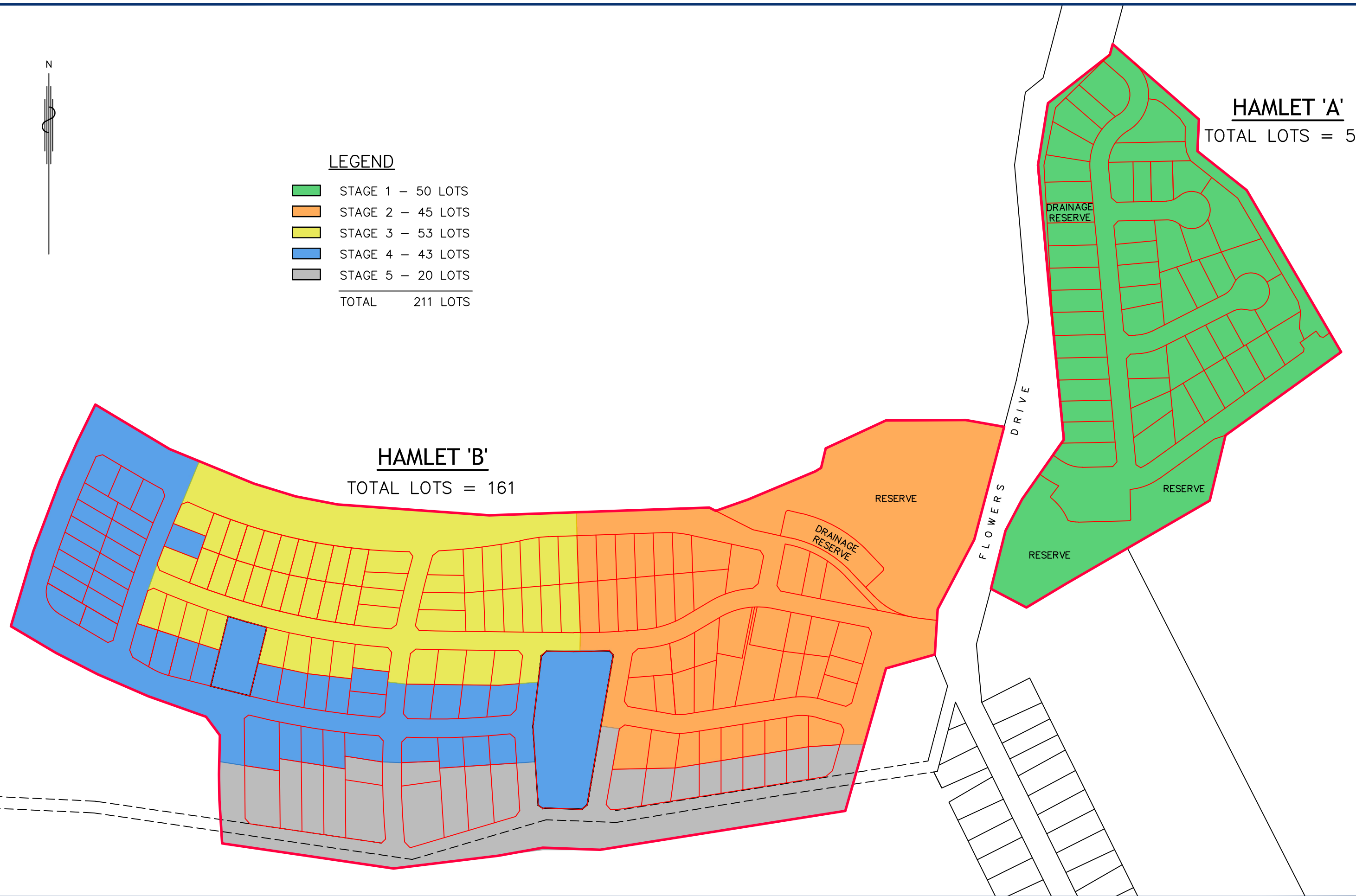

REVISIONS	5	DRAINAGE RESERVE TEXT ADDED	M&P	MAK	KF	28/10/22	COPYRIGHT NOTICE THIS DOCUMENT REMAINS THE PROPERTY OF MONTEATH & POWYS PTY LTD. © CONDITIONS OF USE. THIS DOCUMENT MAY ONLY BE USED BY THE CLIENT FOR THE PURPOSE FOR WHICH IT WAS COMMISSIONED. USE OF THE DOCUMENT FOR ANY OTHER PURPOSE IS NOT PERMITTED UNLESS PRIOR WRITTEN APPROVAL HAS BEEN OBTAINED FROM MONTEATH & POWYS PTY LTD.	Monteath & Powys Pty Ltd PLANNING · SURVEYING · PROJECT MANAGEMENT ENGINEERING DESIGN · UAV · GIS & MAPPING NEWCASTLE · SYDNEY · GUNNEDAH · MUSWELLBROOK MonteathPowys.com.au CERTIFIED SYSTEMS ISO 9001 ISO 14001 ISO 45001	Surveyed	Drafted	Checked	Client	WALLALONG LAND DEVELOPMENTS INDICATIVE STAGING PLAN SUBDIVISION OF LOTS 1 & 2 DP 1180181 FLOWERS DRIVE, CATHERINE HILL BAY	Sheet No.
	4	LOT BOUNDARIES AMENDED STAGE 3 AND STAGE 4	M&P	JS	KF	15/03/22			M&P	MS	GW	Title		1/1
	3	SUPER LOTS AMENDED - LOTS REMOVED AND ROAD ADDED	M&P	MAK	KF	16/09/20			REGISTERED SURVEYOR			Original Size		Revision
	2	SUPER LOTS ADDED	M&P	MAK	KF	08/09/20			@A3 : 1:3000	A3				5
	1	ISSUE TO CLIENT	M&P	MS	GW	18/12/19			DO NOT SCALE			CAD File: 170467D_05		Ref No: 17/0467
No	REVISION	SVY	DFT	CHK	DATE									